



GCK VENTLAB DRAUGHT GENERATOR is a chimney fan that is to be mounted on the top of a chimney (flue or smoke). Its principle is to increase and stabilize chimney draught no matter of what the chimney height, wind speed or other natural conditions are. Draught generator creates underpressure in the chimney duct using a special physical effect – called injection. It is based on creating the stream of airflow in the secondary duct, which creates underpressure in the main chimney duct. Air movement is caused by ventilator which is placed outside the duct. This working mode does not block the chimney duct and does not obstruct the fume extraction as well as allows the device to withstand high temperatures.

It is to be mounted on smoke chimney endings mostly in individual housing.

## Usage:

- when there are wind fluctuations on the chimney duct ending, caused by its bad location
- when there is an unfavorable terrain configuration, with strong and frequent winds
- when there is a lack of chimney draught or it is too weak (f.e. when the chimney duct is too short)
- in order to stabilize and improve the chimney draught in a fireplace or boiler

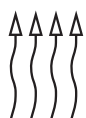

VENTILATION



GAS AND OIL BOILERS



FIREPLACE



WOOD STOVES



DO NOT USE  
ON COAL STOVES



DO NOT USE  
ON COAL BASED FUEL

## GCKV x - d - ML

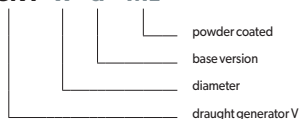

Destination	S	S - gas and oil exhaust ducts
	D	D - smoke ducts from wood burning devices
Material	CH	CH - chrome-nickel sheet 1.4301
	ML	ML - chrome-nickel sheet powder coted

Diameter [mm]	ø150	ø200
Max. efficiency [m³/h]	380	440
Max. underpressure [Pa]	80	30
Single-phase voltage [V/Hz]	230/50	
Nominal power* [W]	90	110
Protection level	IP54	
Max. fumes temperature [°C]	400	
Ambient temperature [°C]	-30 - +65	
Fuse B1	2,5A (0034.6018 SCHURTER)	
Fuse B2	100mA (0034.6018 SCHURTER)	

## Versions of bases

### 1. Square base -PK

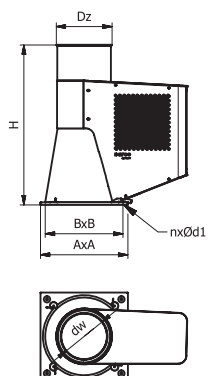

### 2. Base with insulation closing -B-K

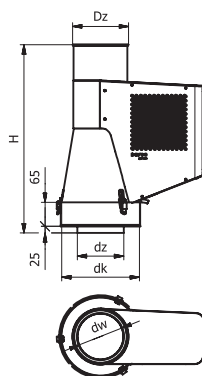

## Airflow charts

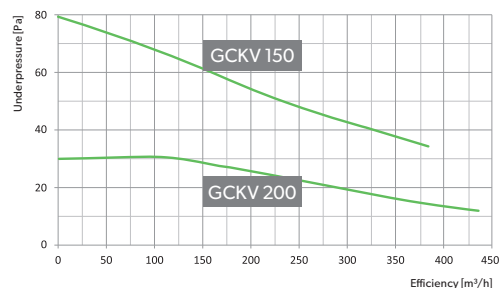

## Connecting diagram

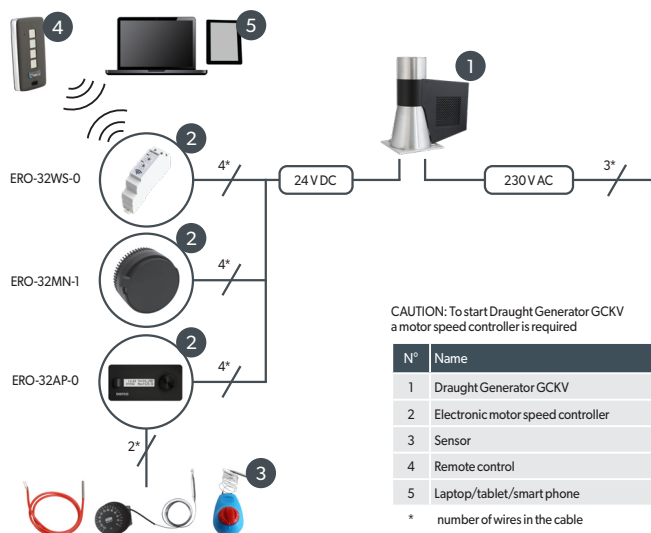

## Measurements table for various inlet diameters

ø 150	Dimensions [mm]									Weight CH [kg]
Base version	dw	dz	H	dk	A	B	Dz	d1	Amount n	
-PK	147.0	-	518	-	282	240	173	6.2	4	9.2
-B-K	-	149	607	253.3	-	-	173	-	-	9.7

ø 200	Dimensions [mm]									Weight CH [kg]
Base version	dw	dz	H	dk	A	B	Dz	d1	Amount n	
-PK	197.0	-	598	-	342	290	230	6.2	4	11.0
-B-K	-	199	686	303	-	-	230	-	-	11.4