

# DARCO ventlab

**V-OPEN** grille is made of mild steel sheet powder coated and chrome-nickel steel sheet (in brushed version). Maximum working temperature is 180 °C. Should be used only inside buildings. Adapted to corner with an angle of 90°.

Fill in the form to valuation/order grille adapter to your needs:

**Order**      **Valuation**

**Type:**    outlet grille    inlet grille

**Color:**    white      black      graphite

**Version:**    with frame      without frame

**Face outer verions:**    painted      brushed



Enter dimensions:

| dimension | mm |
|-----------|----|
| A         |    |
| AR*       |    |
| B         |    |
| BR*       |    |
| C         |    |
| CR*       |    |
| D         |    |
| E         |    |
| F         |    |
| G         |    |
| H         |    |

\* version with frame

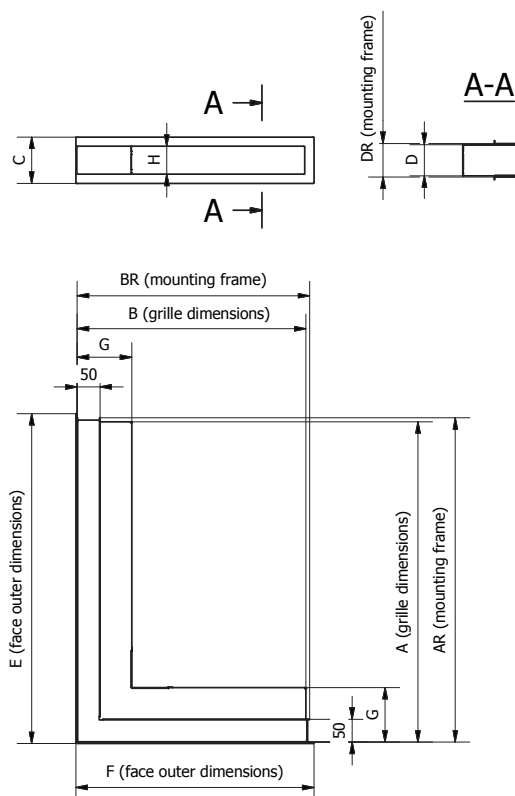

outlet grille:

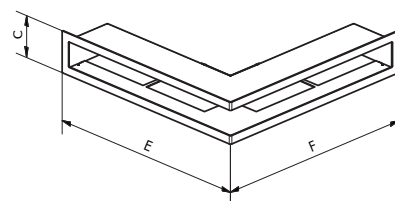

inlet grille:

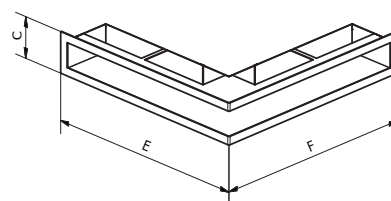

If the grille dimensions cannot be determined, please specify size of the chimney hole:

| dimension | mm |
|-----------|----|
| Z3        |    |
| X1        |    |
| Y2        |    |

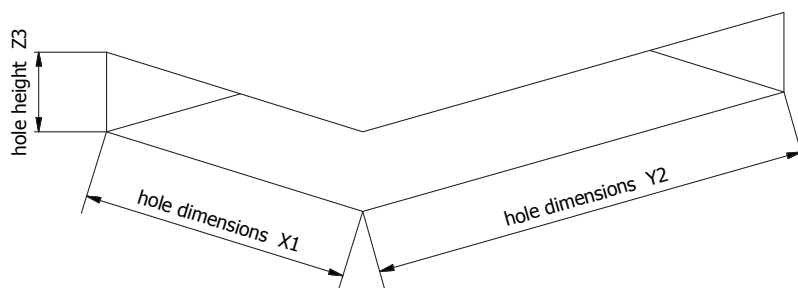

Comments:

Send the completed form to your sales representative or to the e-mail address: [darco@darco.pl](mailto:darco@darco.pl)